

Certification Requirements
 The following certifications shall appear on all plans:

1. Designer's Certification
 "I hereby certify that this plan has been prepared in accordance with the latest Wilmington Standards and Specifications for Stormwater Management and Chapter 20 of the Code of Ordinances of the City of Wilmington."
 Signature: *[Signature]*
 Printed Name and Title: *[Name]*
 Date: *[Date]*

2. Owner's/Developer's Certification
 "I/We hereby certify that any clearing, grading, construction or development, or all of these, will be done pursuant to this plan and that the applicable Stormwater Management conditions and requirements of the City of Wilmington, the State of North Carolina and the Federal Government and its agencies are hereby made part of this plan."
 Signature: *[Signature]*
 Printed Name and Title: *[Name]*
 Date: *[Date]*

NOTE: STANDING WATER CONDITION TO BE ADDRESSED.
 NOTE: BROKEN WALK ALONG PRINCESS PLACE DRIVE TO BE REPAIRED.
 NOTE: POWER POLES IN CONFLICT WITH INTERSECTION TO BE RELOCATED.

SITE DATA

TOTAL AREA	17.72 ACRES
ZONING	O46
BUILDING AREA (TOTAL)	140,808 SF
BUILDING AREA (IMPERVIOUS)	62,736 SF
PARKING SPACES REQUIRED	258
PARKING SPACES PROVIDED	318
ASPHALT PARKING AREA	66,822 SF
CONCRETE AREA	33,500 SF
LANDSCAPING AREA REQUIRED:	12,776 SF
LANDSCAPING AREA PROVIDED:	12,865 SF

- NOTES:**
- ALL CONSTRUCTION WILL COMPLY WITH THE REQUIREMENTS WITH THE CITY OF WILMINGTON TECHNICAL STANDARDS AND SPECIFICATIONS MANUAL.
 - PROJECT SHALL COMPLY WITH CITY OF WILMINGTON CROSS CONNECTION CONTROL REQUIREMENTS. WATER METER(S) CANNOT BE RELEASED UNTIL ALL REQUIREMENTS ARE MET. CALL 910-343-3910 FOR MORE INFORMATION.
 - IF THE CONTRACTOR DESIRES CITY WATER FOR CONSTRUCTION HE SHALL APPLY IN ADVANCE FOR THIS SERVICE AND MUST PROVIDE A REDUCED PRESSURE ZONE (RPZ) BACKFLOW PREVENTION DEVICE ON THE DEVELOPERS' SIDE OF THE WATER METER BOX.
 - ANY IRRIGATION SYSTEM SUPPLIED BY CITY WATER SHALL COMPLY WITH THE CITY'S CROSS CONNECTION CONTROL REGULATIONS. CALL 910-343-3910 FOR INFORMATION.
 - ALL DUMPSTERS AND HVAC UNITS SHALL BE SCREENED TO CITY OF WILMINGTON STANDARDS.
 - ESTIMATED GALLONS PER DAY FOR WATER AND SEWER ARE AS FOLLOWS:
 WATER: 69,458 GPD
 SEWER: 63,144 GPD
 - ALL SITE LIGHTING SHALL BE CONTAINED ON-SITE.
 - NO WETLANDS EXIST ON SITE.

REVISIONS

No.	Date	Description	By

TRIPP ENGINEERING, P.C.
 SITE, GRADING, DRAINAGE, EROSION CONTROL,
 STORMWATER MANAGEMENT AND UTILITY PLAN
BIRCHWOOD PARK
 WILMINGTON, NORTH CAROLINA

419 Chestnut Street
 Wilmington, North Carolina 28401
 Phone 910-763-5100
 Fax 910-763-5681
 © 2001 TRIPP ENGINEERING, P.C.

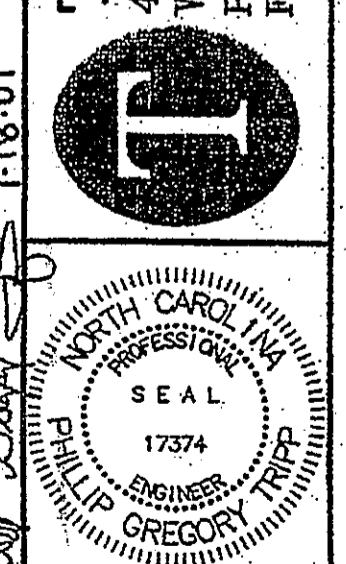

DATE: 07-18-01
 DESIGN: PGT
 DRAWN: JHD/MVL

C1
 SHEET 1 OF 3
 01040

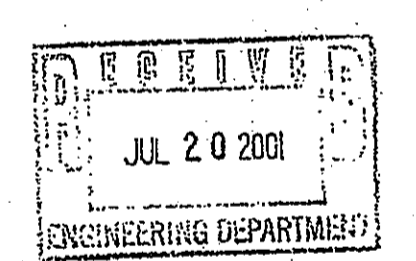

LEGEND

- EXISTING CONTOUR
- PROPOSED SPOT ELEVATION
- INLET w/ INLET PROTECTION
- STORMWATER RUNOFF DIRECTION
- TEMPORARY SILT FENCE
- CONCRETE AREA
- LANDSCAPING w/ AREA
- LIMITS OF DISTURBANCE

SITE PLAN
 1" = 60'

JUL 19 2001

THIS IS
A REDUCTION

BIRCHWOOD
ENTRY GATE
Scale 1" = 10'

- dimensions - gate location
- ▬ ex. sidewalk
- ▬ ex. apron
- ▭ ex. asphalt

PRIVATE
SEWER

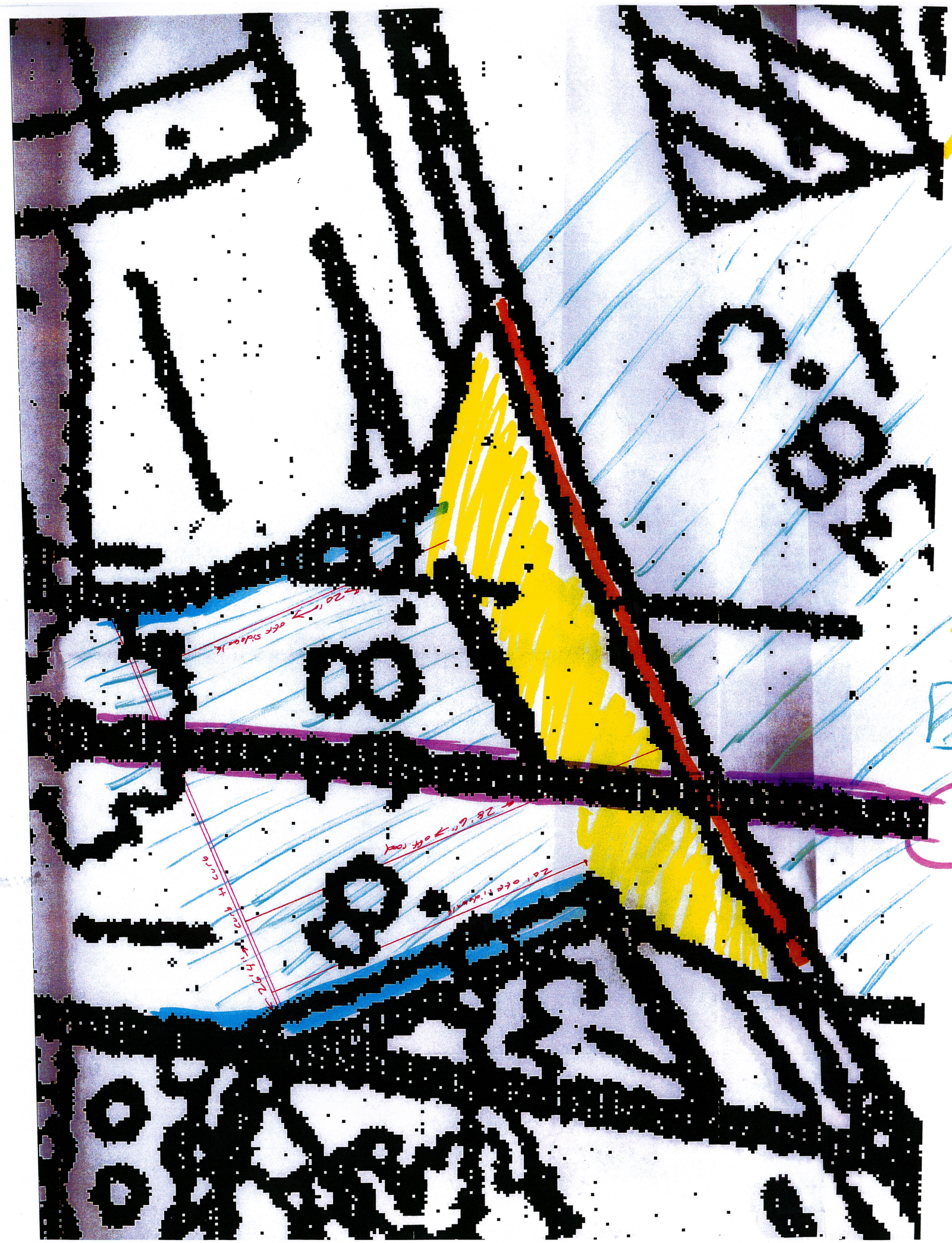

RECEIVED
SEP 23 2016
PLANNING DIVISION

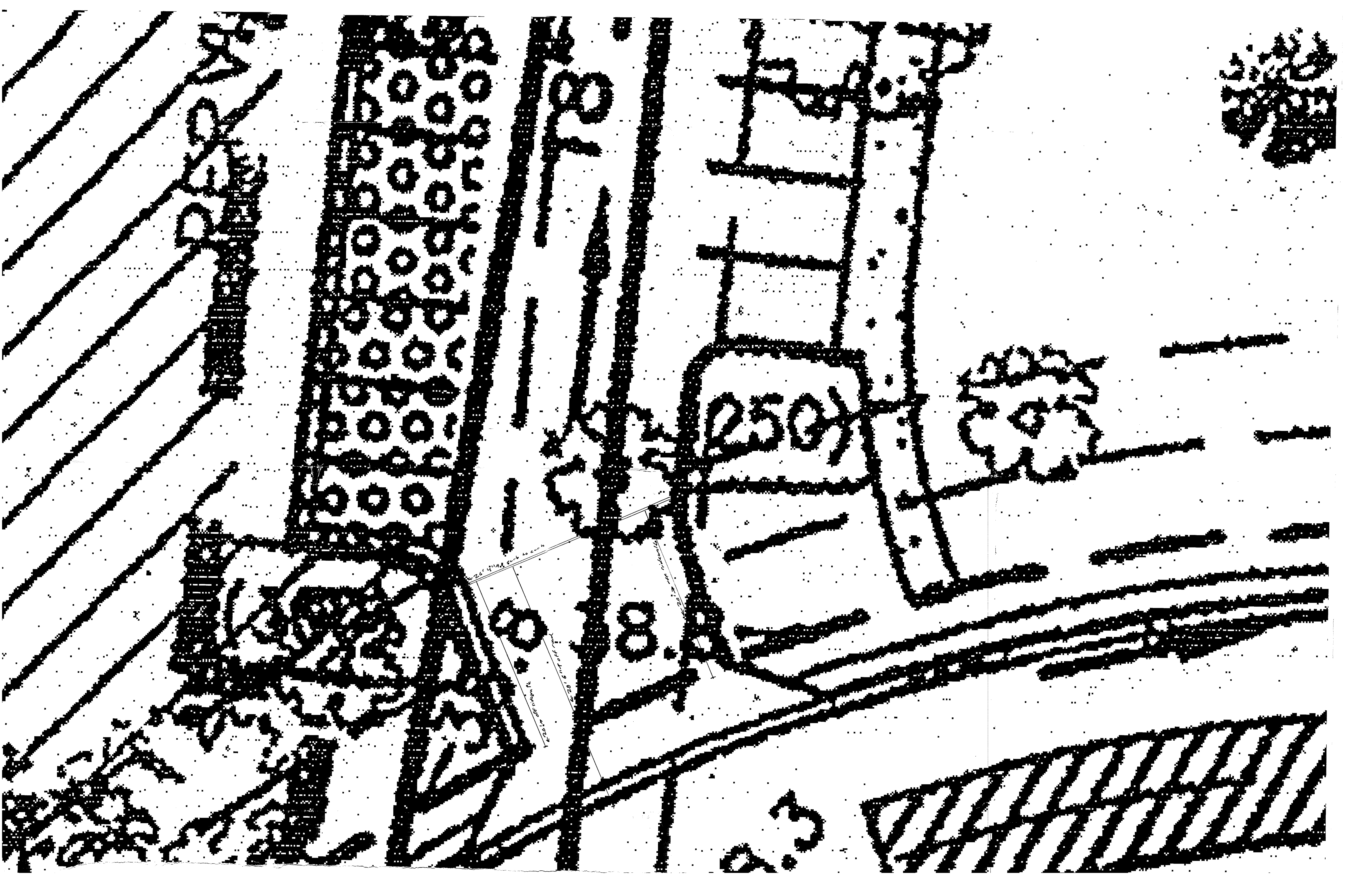

26' 4 1/2" sunk to curb

Staircase 2' 0" x 2' 0"

2' 0" x 2' 0" off ramp

250

8



April 4, 2016

Wilmington City Planning
Technical Review Committee
102 North Third Street - Post Office Box 1810
Wilmington, North Carolina 28402-1810

To Whom It May Concern:

Attached for your review is a site map of Birchwood Park Apartments. Highlighted is the location and standard for installation of exit only barrier gate. We propose to place two (2) exit only, 14' barrier gates, with battery back-up, a siren operated system, and a Knox box. Attached are the specs. There has been an increase in criminal activity in the area. Vehicles frequently use that entrance to gain access to the property and conduct illegal practices. We feel that installing an exit only gate would be a proactive approach to deter this negative element from entering the community. I look forward to your response. Thank you.

Sincerely,

Dominic Becker

RECEIVED
MAY 4 2016
PLANNING DIVISION

①

10 South Cardinal Drive | Wilmington, NC 28403
Phone 910.777.4192 | Fax 910.251.2382
dbecker@tributeproperties.com

cell



Access Control Solutions

Since 1948

RECEIVED
MAY 4 2016
PLANNING DIVISION

1601 Barrier Gate

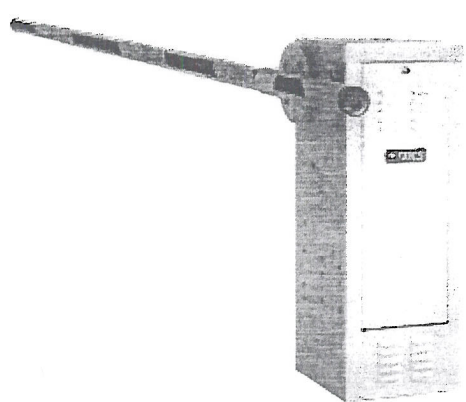

- Automatic p.a.m.s. sequencing with slide and swing gates
- Folding arm kits available for low headroom applications
- Barrier arms available in aluminum/wood or plastic with optional foam padding

The 1601 operator is designed for single lane (14 ft. max) vehicular traffic control in high traffic commercial and industrial applications. The 1601 operator is designed so that it can be mounted on either the left or right hand side of the roadway. The operator can be equipped with a DC convenience open package (optional) that will automatically raise the arm in the event of a power outage.

Arm Options

Arm Type	Max. Arm Length (Ft.)	Style	Folding Option
Plastic	12	2.5x2.5 in. Square	Yes
Wood	14	.75x.75 in. Rectangular	Yes
Aluminium	14	3 in. Round	Yes
Foam Padding available for Aluminium / Wood			

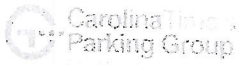

PROPOSAL # 391P84

Carolina Time Equipment Co, Inc. | Cincinnati Systems, Inc. | Time & Parking Controls, Inc.

TO:
DOMINIC BECKER
TRIBUTE PROPERTIES

FROM:
Nick Danikas
3931 Mega Drive Suite 13
Myrtle Beach , SC , 29588

WILMINGTON , NC 28405

Phone: (843) 448-7200
Fax: (843) 215-7363
Email: nick.danikas@carolinatime.net

FOR:
TRIBUTE PROPERTIES- REVISED QUOTE
BIRCHWOOD PARK WILMINGTON, NC 28405

Warranty- 1-Yr Parts & Labor

Proposal expires on- November-10-2016

Delivery- 4-6 weeks
Terms- 50% down, 50% at delivery

We hereby submit specifications and estimates for:

- 1 - LIFTMASTER SL-585 SLIDE GATE OPERATOR WITH 1 H/P MOTOR- HANDLES 35' GATE
- 3 - LOOPS 6'X6' INGROUND LOOPS, OPEN, SAFETY
- 1 - MISC. 3'X3'X2' CONCRETE PADS
- 1 - SOS SIREN OPEN SYSTEM
- 1 - KNOX SWITCH 3501 KNOX SWITCH
- NOTE SLIDE GATE, ELECTRICAL TO SITE BY OTHERS

Subject to all Terms and Conditions as specified on attached pages

Finished Goods & Software	\$ 4,527
Labor	1,680
Other items (including freight)	741
Sales Tax	464

Accepted by: DOMINIC BECKER _____ Date: _____ Total Price \$ 7,413

Sincerely,
Nick Danikas